



GY



GA / GB / GC / GX



FMA



SSCA / SSGX / SSGB / SSGC



SR



GX



GP / GT / GF / GH / GK

Features and Benefits

The Flow Regulator from Invensys Controls is the industry's control for delivering a constant volume of water flow over a wide pressure range. The Flow Regulator's control mechanism is a flexible orifice which varies its effective area inversely to the applied pressure. Key features include:

- Threshold pressure acts as a fixed orifice. (See Flow Characteristics on next page.)
- Orifice maintains desired output even when threshold points cause the insert to distort. (See chart on next page.)
- Flow rates are maintained to within $\pm 15\%$ up to a pressure drop of 125 PSI. (Flow rate varies due to manufacturing tolerances and water temperatures.)
- Regulators can meet a maximum system pressure of 200 PSI.
- Multi-orifice flow inserts in regulators with rates between 1 GPM and 4 GPM break up the water discharge pattern and minimize the sound made when water passes through the restriction.

**Flow Regulator formally manufactured under the Dole brand.*

Flow Regulator Applications

Flow Regulators are used in a wide variety of applications, such as:

- Tankless heaters
- Cooling towers
- Fan coils
- Water softeners
- Drinking fountains
- Water filters
- Irrigation systems
- Ground water heat pumps
- Water purifiers
- Eye washes
- Fire sprinkler systems
- Filling equipment
- Dispensing machines
- Pumps (well and packing water)



Proudly made in the USA

FLOW CHARACTERISTICS

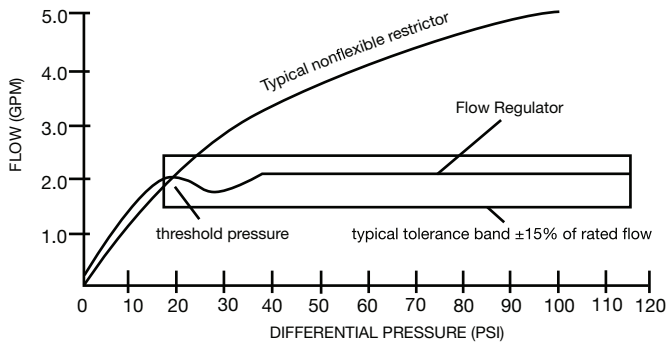

OPERATING PRINCIPLE

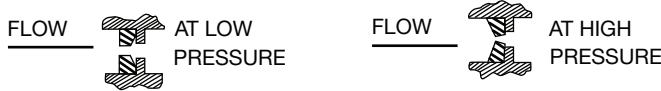

G-SERIES FLOW REGULATORS: Steel Housing/Zinc Plated

GP		<ul style="list-style-type: none"> • 1 1/4" MNPT - Inlet Outlet • 1.0 to 30.0 GPM • 12 oz. Net Weight
GT		<ul style="list-style-type: none"> • 1 1/2" MNPT - Inlet Outlet • 1.0 to 30.0 GPM • 1 lb. Net Weight
GF		<ul style="list-style-type: none"> • 2" MNPT - Inlet Outlet • 10.0 to 30.0 GPM • 1 lb. 10 oz Net Weight
GH		<ul style="list-style-type: none"> • 2 1/2" MNPT - Inlet Outlet • 30.0 to 90.0 GPM • 3 lb. Net Weight
GK		<ul style="list-style-type: none"> • 3" MNPT - Inlet Outlet • 30.0 to 120.0 GPM • 3 lb. 7 Oz Net Weight

G-SERIES FLOW REGULATORS: Brass Housing/Nickel Plated or 316 Stainless Housing

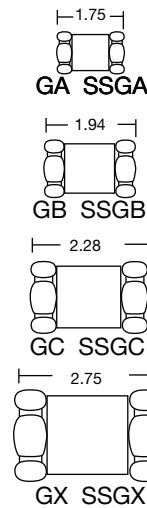

- 3/8" FNPT - Inlet Outlet
- 0.06 to 1.0 GPM
- 3 oz. Net Weight
- 1/2" FNPT - Inlet Outlet
- 1.0 to 6.0 GPM
- 4 oz. Net Weight
- 3/4" FNPT - Inlet Outlet
- 1.0 to 11.5 GPM
- 8 oz. Net Weight
- 1" FNPT
- 1.0 to 30.0 GPM
- 12 oz. Net Weight

FRS-SERIES FLOW REGULATORS

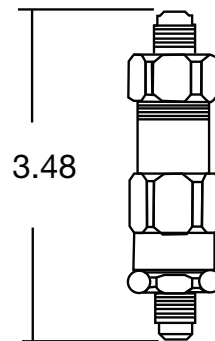

- 1/8" Flare - Inlet and Outlet
- 0.06 to 1.0 GPM
- Serviceable 100 x 90 Mesh Monel Screen
- Brass Housing
- 5.5 oz Net Weight

GY-SERIES FLOW REGULATOR

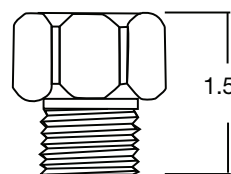

- 3/4" MNPT - Inlet
- 3/4" FNPT - Outlet
- 1.0 to 11.5 GPM
- Brass Housing
- 4.5 oz Net Weight

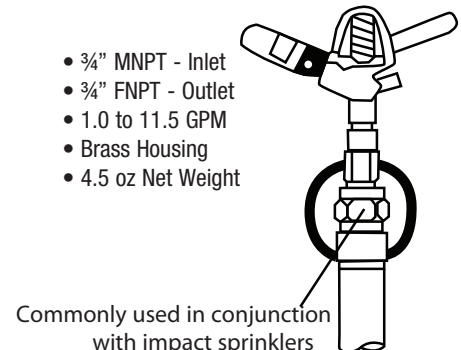

Flow Rate in GPM	Standard Flow Rates Available Within Each Model Type																	
	FMA	FMC	FRS	SR	GA	GB	GC	GF	GH	GK	GP	GT	GX	GY	SSGA	SSGB	SSGC	SSGX
0.06			•1		•1										•1			
0.13					•3										•1,3			
0.19			•3		•3										•3			
0.25			•3		•3										•3			
0.35			•3		•3										•			
0.50	•3	•3	•3		•3										•3			
0.75	•3	•3	•3		•3										•3			
1.00	•2	•2	•3		•3	•2	•3				•3	•3	•3	•3	•3	•3	•3	•3
1.50	•2	•					•				•	•	•	•		•2,3	•	•
2.00		•2		•2		•2	•3				•3	•3	•3	•3		•2	•	•
2.50		•2		•2		•2	•				•	•	•	•		•2	•	•
3.00		•2		•2		•2	•				•	•	•	•		•2	•	•
3.50		•2				•	•				•	•	•	•		•	•	•
4.00						•2	•				•	•	•	•		•2	•	•
5.00		•2				•	•				•	•	•	•		•	•	•
6.00						•	•				•	•	•	•		•	•	•
7.00							•				•	•	•	•			•	•
8.00							•				•	•	•	•			•	•
9.00							•				•	•	•	•			•	•
10.0							•	•			•	•	•	•			•	•
11.5							•	•									•	
12.0								•			•	•	•					•
13.5								•			•	•	•					•
15.0								•			•	•	•					•
20.0								•			•	•	•					•
25.0								•			•	•	•					•
30.0								•	•	•	•	•	•					•
35.0									•	•								
40.0									•	•								
45.0									•	•								
50.0									•	•								
55.0									•	•								
60.0									•	•								
65.0									•	•								
70.0									•	•								
75.0									•	•								
80.0									•	•								
85.0									•	•								
90.0									•	•								
95.0										•								
100.0										•								
105.0										•								
110.0										•								
115.0										•								
120.0										•								
	15-25	15-25	15-25	15-25	15-25	15-25	15-25	15-25	15-25	15-25	15-25	15-25	15-25	25-30	15-25	15-25	15-25	152-5

Note: (1) Use of a strainer is recommended. (2) Indicates multi-orifice flow washer is used
(3) Indicates the internal flow washer is a Ethylene Propylene compound. All others are Buna-N

Note: All Flow Regulators are recommended for potable water below 180°F, have flow tolerance of ± 15% and are designed for a maximum system pressure of 200 PSI.

FOR LAVATORY FIXTURES AND SHOWER HEADS

FMA

Flow Rates: 0.5 to 1.5 GPM

Connections:

Inlet: 3/8" MNPT

Outlet: 3/8" FNPT

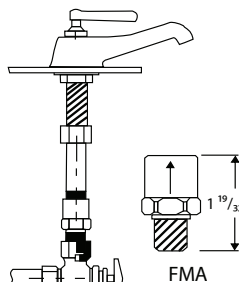

Installed at the stop

FMC

Flow Rates: 0.5 to 4.0 GPM

Connections:

Inlet: 1/2" MNPT

Outlet: 1/2" FNPT

(Straight Pipe Threads)

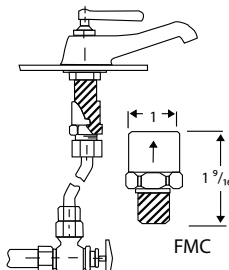

Installed at the faucet shank

SR

Flow Rates: 1.5 to 3.0 GPM

Connections:

Inlet: 1/2" FNPT

Outlet: 1/2" MNPT

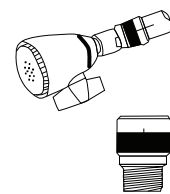

SR

Installed behind showerhead

Available Flow Rates in Gallons Per Minute (GPM)¹

Fixture Type	Models	0.5 ²	0.75 ²	1.0	1.5	2.0	2.5	3.0	4.0	Qty Generally Req'd
Lavatories	FMA	•	•	•	•					2
Large 1.0-1.5 GPM ²	FMC	•	•	•	•	•	•	•	•	2
*Sinks, Commercial Kitchen	FMC or SR3	•	•	•	•	•	•	•	•	2
*Sinks, Domestic Kitchen	FMC or SR3	•	•	•	•	•	•	•	•	2
*Sinks, Small	FMC or SR3	•	•	•	•	•	•	•	•	2
*Sinks Slop	FMC or SR3	•	•	•	•	•	•	•	•	2
*Sinks, Service	FMC or SR3	•	•	•	•	•	•	•	•	2
Showers	SR4				•	•	•	•		1
Ice Water Taps	FMA, FMB	•	•	•	•					1
Drinking Fountains	FMA, FMB	•	•	•	•					1

NOTES

* Check Application Chart on the previous page for specific flow rates.

1. All standard available flow rates for each model are shown. Commonly recommended flow rates are shades or noted.
2. Regulators with 0.5 and 0.75 GPM are available with a single orifice flow washer only.
3. The SR series shower regulator may be used on deck type faucets having 1/2" FNPT tapping, flow rates from 1.5 to 3.0 GPM only.
4. Desirable flow rates depend on the make and capacity of the shower head.

All plumbing fixture flow regulators are nickel plated except for the SR series shower regulators, which are chrome plated. The approximate net shipping weight for fittings is 3oz. Each

Flow Regulators for lavatories, fixtures and showers are found in:

- Schools
- Hotels
- Homes
- Apartments etc.
- Office Buildings
- Motels
- Businesses



Mathews Denver
Authorized Distributors
4850 Nome St.
Denver, Colorado 80239
303-825-5376
mathewsdenver.com